

AMERICAN AVK RESILIENT SEATED DUCTILE IRON GATE VALVE
250 PSI, Tested to AWWA C509 / C515 (NRS) for Indicator Post,
CWP Tested to 350 PSI Flanged x Flanged Ends to ASME B16.42 Class 250
- Valve Sizes 4" - 12" Laylength to ASME B16.10

45/FFHP
FLxFL PIV

Use:
 For water and neutral liquids to maximum 160°F.

Tests:
 Hydraulic test to AWWA C509:
 Shell Test: 500 PSI
 Seat Test: 250 PSI
 Hydraulic test CWP (Cold Working Pressure):
 Shell Test: 525 PSI
 Seat Test: 350 PSI
 Operating Torque Test

Optional Materials:

Stem	Stainless steel AISI 430F Stainless steel AISI 304 Stainless steel AISI 316
Bonnet Bolts	Stainless steel AISI 304, Stainless steel AISI 316, Zinc Plated steel sealed with hot melt
Gland Bolts	Stainless steel AISI 316, Zinc Plated steel

Standard Materials:

Body, Bonnet, Post Indicator Plate, Wrench Nut	Ductile iron ASTM A536 (Wrench Nut-painted black for open left, red for open right)
Coating	Electrostatically applied fusion- bonded epoxy-resin Meets or exceeds AWWA C550
Stem	4"-12" Standard: Low Zinc Bronze ASTM B763
Anti Friction Washers	Polyamide
Wedge	Ductile iron ASTM A536 encapsulated with EPDM-rubber compound
Wedge Nut, Thrust Collar	Bronze
Bonnet Bolts	4" - 8" Stainless Steel - 304 sealed with hot melt Grade 8 Steel for 10"-12" sealed with hot melt
Gland Bolts	Stainless Steel - 304 Hexagon bolt
Bonnet Gasket, Wiper Ring, O-Ring Stem Seals, O-Ring Gland Seal	ASTM D2000 Buna "N" nitrile rubber

Approvals:

*UL/ULC Listed
 *FM Approved
 Certified to: ANSI/NSF 61, ANSI/NSF 372
 * Approved at 250 PSI working pressure





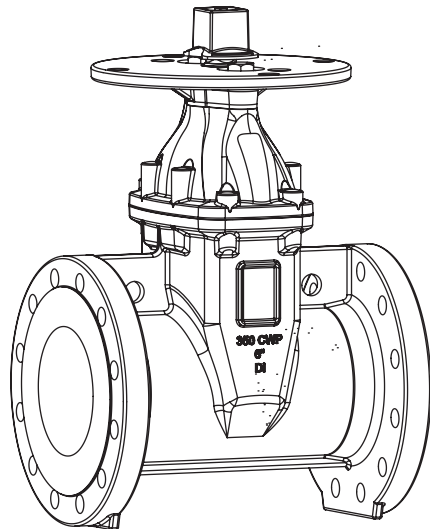

AMERICAN AVK RESILIENT SEATED DUCTILE IRON GATE VALVE
250 PSI, Tested to AWWA C509 / C515 (NRS) for Indicator Post,
CWP Tested to 350 PSI Flanged x Flanged Ends to ASME B16.42 Class 250
- Valve Sizes 4" - 12" Laylength to ASME B16.10

45/FFHP
FLxFL PIV

Component List:

- | | | |
|---------------------------|------------------------------|-----------------------------|
| 217. Bonnet | 226. Wiper Ring | 232. Lower Stem Seal O-Ring |
| 218. Bonnet Gasket | 227. Gland Flange Bolt | 235. Anti-Friction Washer |
| 219. Body | 229. Gland O-Ring | 236. Low Zinc NRS Stem |
| 224. Post Indicator Plate | 230. Upper Stem Seal O-Rings | 237. Wedge |
| 225. Wrench Nut | 231. Stem Seal Bushing | |

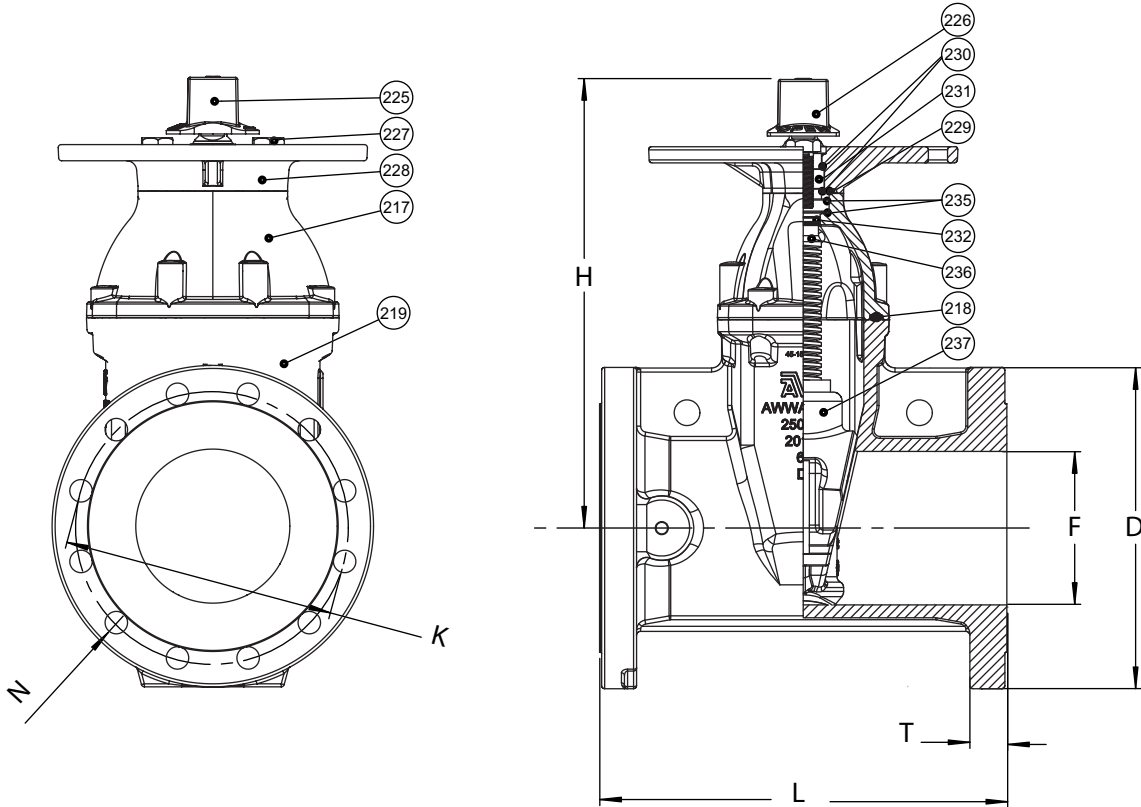

RefNo.	Size	D	F	H	K	L	N	T	Flange Holes	Turns to Open	Weight Lbs.
45-100-FFHP	4"	10.00"	4.00"	13.50"	7.88"	12.00"	0.88"	1.25"	8	14	111
45-150-FFHP	6"	12.50"	6.00"	17.50"	10.63"	15.88"	0.88"	1.44"	12	21	181
45-200-FFHP	8"	15.00"	8.00"	21.50"	13.00"	16.50"	1.00"	1.62"	12	26	264
45-250-FFHP	10"	17.50"	10.00"	24.75"	15.25"	18.00"	1.12"	1.88"	16	32	386
45-300-FFHP	12"	20.50"	12.00"	27.75"	17.75"	19.76"	1.25"	2.00"	16	38	561

